

UNCONTROLLED IF PRINTED

$\sqrt{Ra6.3}$ ($\sqrt{Ra0.4}$)

D
C
B
A

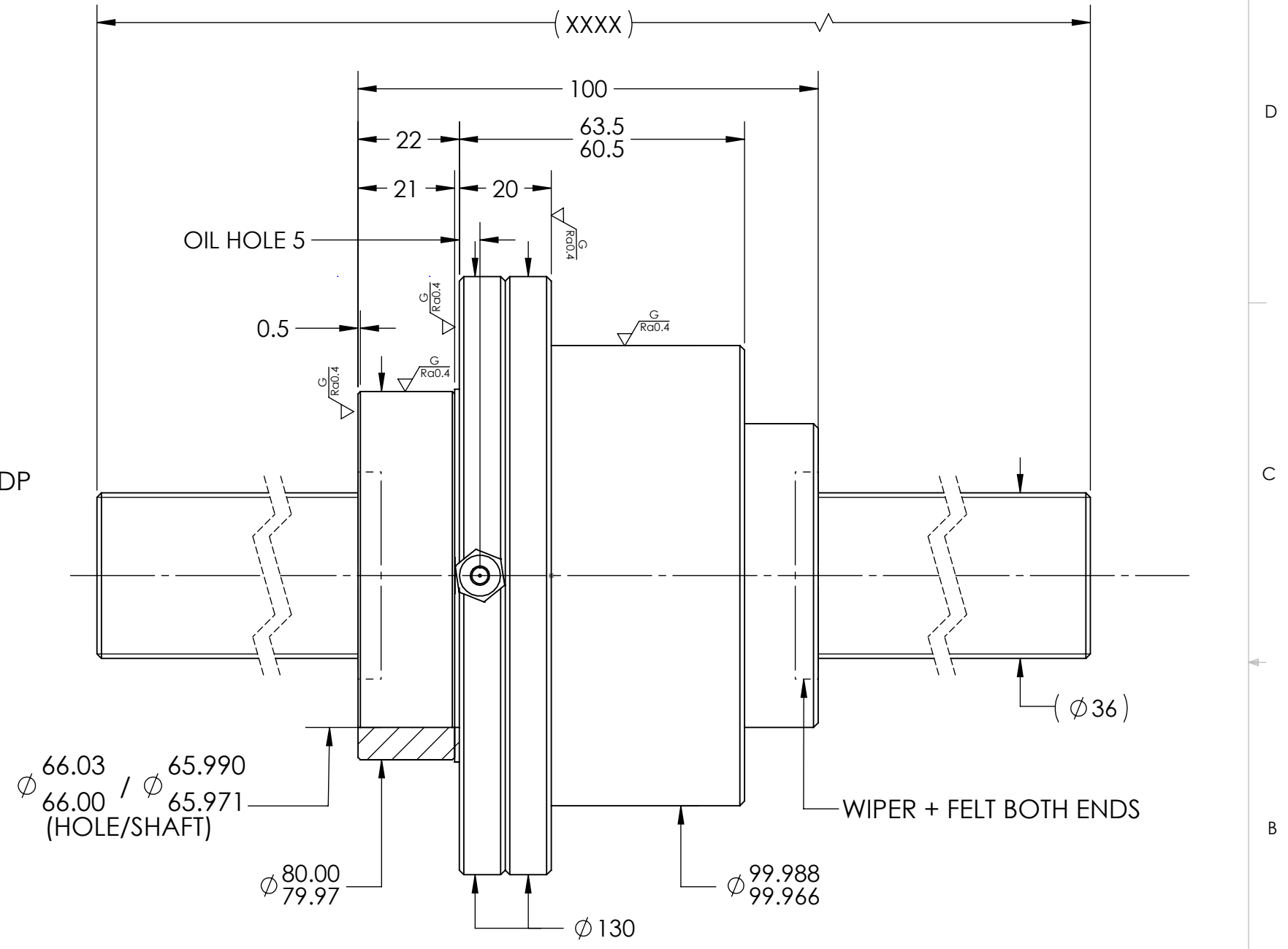
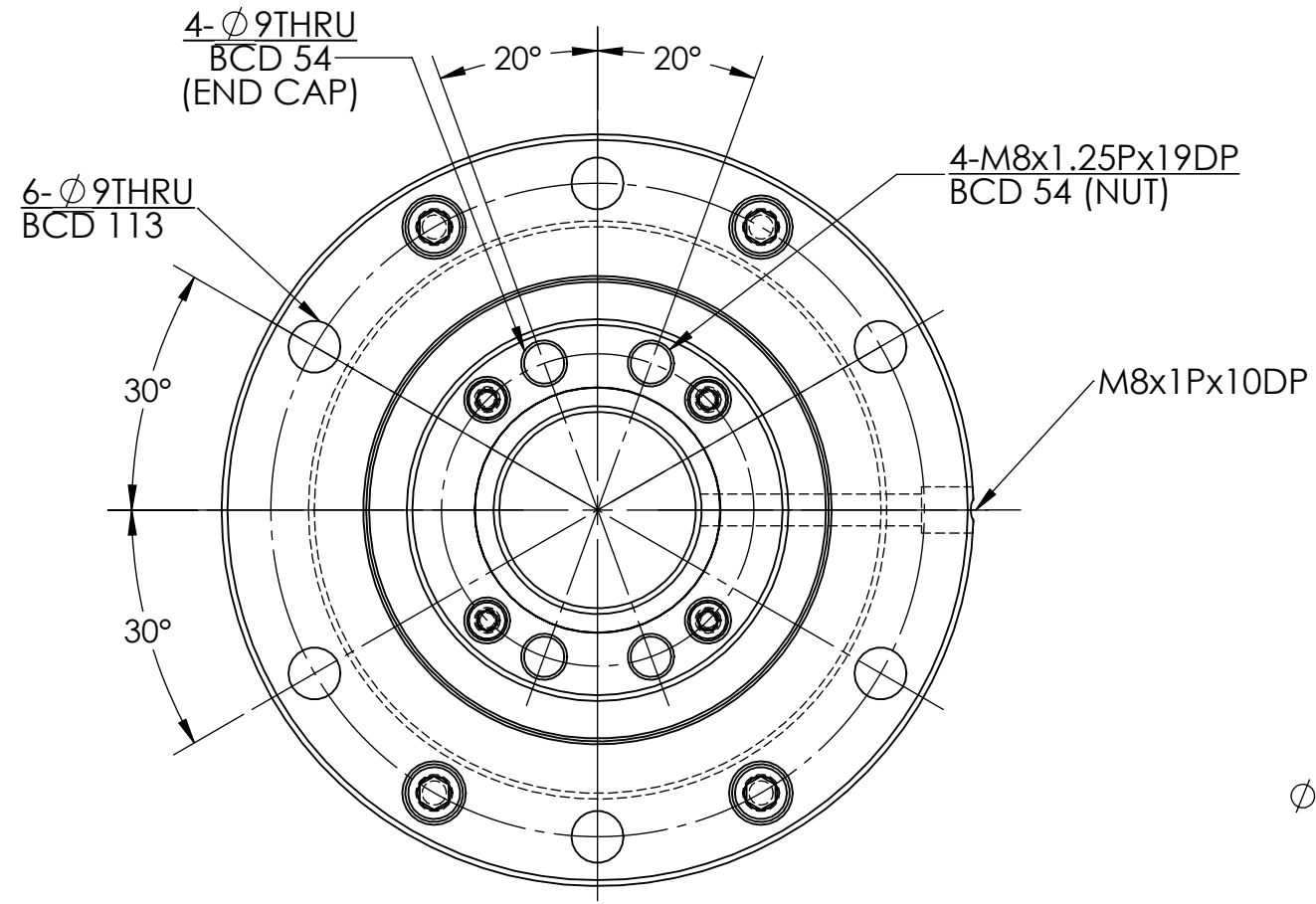

DYNAMIC (BEARING) (kgf)	2189
STATIC (BEARING) (kgf)	4990
PRELOAD(kgf)	~
R.D.	31.407
S.F. (kgf)	~
DRAG TRQ(kgf-cm)	~
TURN DIRECTION	R
P.C. DIA.	36.275
BALL DIA.	4.763
BACKLASH	0.05 MAX
CIRCUIT	1.8*2
LEAD ANGLE	17.53
DYNAMIC (kgf)	1960
STATIC (kgf)	6210
LEAD/PITCH	36/9

BREAK SHARP EDGES UNLESS OTHERWISE SPECIFIED									
ROUGH M/C	FIN M/C	GRD	MATERIAL		SHAFT:CF53/Equiv.				
$\sqrt{Ra25}$	$\sqrt{Ra6.3}$	$\sqrt{Ra0.4}$	NUT:SNM220/Equiv.		HRC 56~62				
TOLERANCE mm									
UP	6	30	120	300	600	1200	2400	2400	
TO	6	30	120	300	600	1200	2400	OVER	
± 0.1		± 0.2		± 0.3		± 0.4		± 0.5	
± 0.8		± 1.0		± 1.5					
DATE			INITIALS			HIWIN CORPORATION			
DRAWN 09/30/2022			D.W			12455 Jim Dhamer Dr, Huntley, IL 60142			
CHECKED 02/01/2023			T.C.			TITLE:			
MFG APPR. 02/01/2023			A.H			STANDARD STOCK BALLSCREW			
THREAD LENGTH			PART NUMBER:						
+0			4R36-36S2-DFSHR1SP-XXX-XXX-0.05						
-0			SIZE		DWG. NO.		REV		SCALE
v300p:			B		W-SBS-36-36-A01		N/C		1:1

HIWIN CONFIDENTIAL

8 7 6 5 4 3 2 1