

UNCONTROLLED IF PRINTED

$\sqrt{Ra6.3}$ ($\sqrt{Ra0.4}$)

D
C
B
A

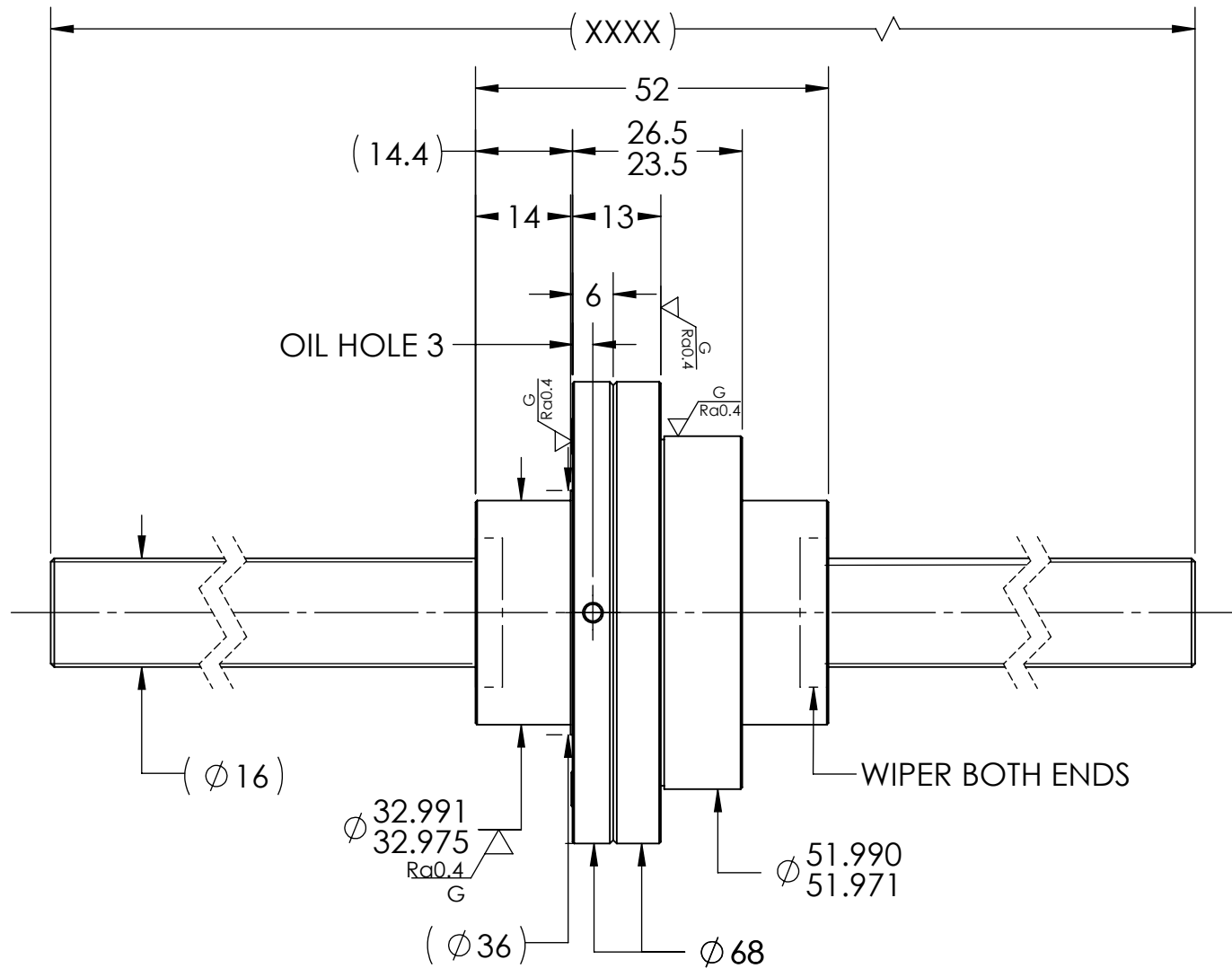
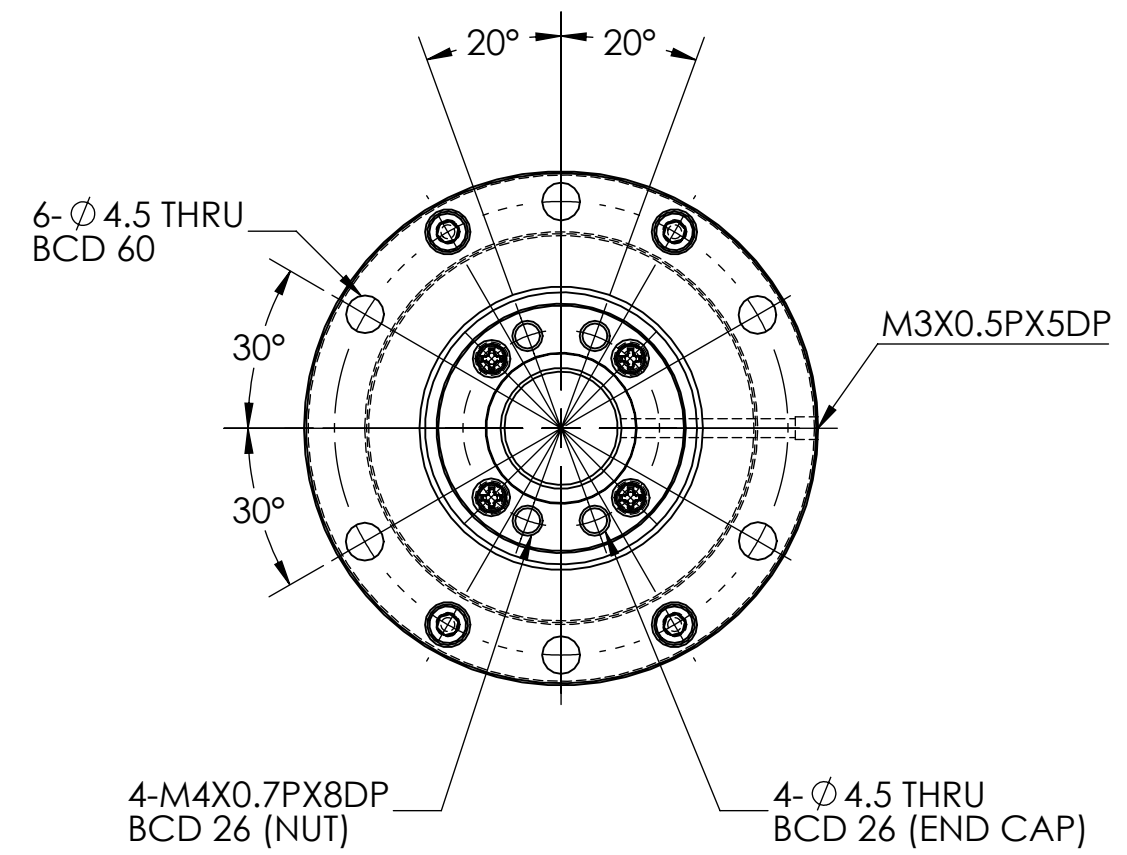

DYNAMIC (BEARING) (kgf)	1299	BREAK SHARP EDGES UNLESS OTHERWISE SPECIFIED									
STATIC (BEARING) (kgf)	1826	ROUGH M/C	FIN M/C	GRD		MATERIAL	SHAFT:CF53/Equiv.				
PRELOAD(kgf)	~	$\sqrt{Ra25}$	$\sqrt{Ra6.3}$	$\sqrt{Ra0.4}$		THREAD BALL TRACK	NUT:SNM220/Equiv.				
R.D.	13.344	TOLERANCE mm									
S.F. (kgf)	~	UP	6	30	120	300	600	1200	2400	2400	OVER
DRAG TRQ(kgf-cm)	~	TO	6	30	120	300	600	1200	2400	2400	OVER
TURN DIRECTION	R	± 0.1	± 0.2	± 0.3	± 0.4	± 0.5	± 0.8	± 1.0	± 1.5		
P.C. DIA.	16.62	DATE	INITIALS	HIWIN CORPORATION							
BALL DIA.	3.175	DRAWN	7/14/2022	D.W	12455 Jim Dhamer Dr, Huntley, IL 60142						
BACKLASH	0.04 MAX	CHECKED	02/01/2023	T.C.	TITLE: STANDARD STOCK BALLSCREW						
CIRCUIT	1.8*2	MFG APPR.	02/01/2023	A.H	PART NUMBER: 4R16-16S2-DFSHR1-XXX-XXX-0.05						
LEAD ANGLE	17.04										
DYNAMIC (kgf)	708	SIZE	DWG. NO.		REV	SCALE					
STATIC (kgf)	1382	B	W-SBS-16-16-A02		N/C	1:1					
LEAD/PITCH	16/4	v300p:									

HIWIN CONFIDENTIAL

8 7 6 5 4 3 2 1